



Photography: Max Lerouge – LMCU

ARCHITECTURE ♦ MUSEUM

## Lille Modern Art Museum | Manuelle Gautrand Architecture

Editor: Ruba Ahmed

Designed by **Manuelle Gautrand Architecture**, The project concerns the refurbishment and the extension of the Lille Modern Art Museum in a magnificent park at Villeneuve d'Ascq. The existing building, designed by Roland Simounet in 1983, is already on the Historic monuments list.

The project aims at building up the **museum** as a continuous and fluid entity, this by adding new galleries dedicated to a collection of Art Brut works, from a traveling movement that extrapolates existing spaces. A complete refurbishment of the existing building was next required, some parts were very worn.



Photography: Max Lerouge – LMCU

In spite of the heritage monument status of Simounet's **construction**, rather than set up at a distance, we immediately opted to seek contact by which the extension would embrace the existing buildings in a supporting movement. I tried to take my cue from Roland Simounet's architecture, 'to learn to understand', so as to be able to develop a project that does not mark aloofness, an attitude that might have been seen as indifference.

The architecture of the extension wraps around the north and east sides of the existing arrangement in a fan-splay of long, fluid and organic volumes. On one side, the fan ribs stretch in close folds to shelter a café-**restaurant** that opens to the central patio; on the other, the ribs are more widely spaced to form the five galleries for the Art Brut collection.



The Art brut galleries maintain a strong link with the surrounding scenery, but they are also purpose-designed to suit the works that they house: atypical pieces, powerful works that you can't just glance at in passing. The folds in these galleries make the space less rigid and more organic so that visitors discover artworks in a gradual movement. The architecture is partly introverted, to protect artworks that are often fragile and that demand toned down half-light.

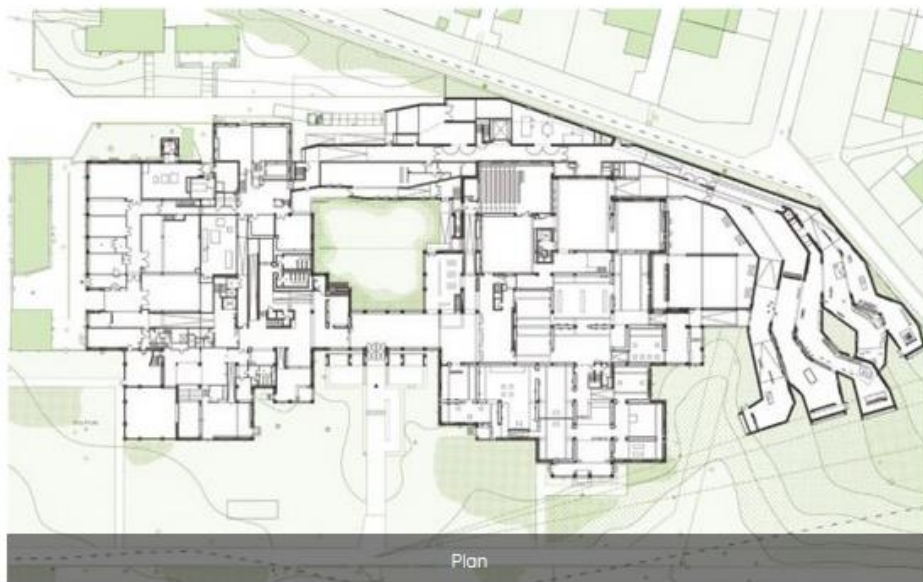

At the extremity of the folds - meaning the galleries - a large bay opens magnificent views onto the surrounding parkland, adding breathing space to the visit itinerary. These views make up for the half-light in the galleries: the openwork screens in front of the bays mediate with strong light and parkland scenery, a feature that recalls Simounet's generous arrangements in the galleries that he designed. Envelopes are sober: smooth untreated **concrete**, with moldings and openwork screens to protect the bays from too much daylight. The surface concrete has a slight color tint that varies according to an intensity of light.





**Project Info:**

**Architects:** Manuelle Gautrand Architecture

**Location:** Chemin John Coltrane, 59650 Villeneuve-d'Ascq, France

**Architect in Charge:** Roland Simounet

**Project Manager:** Yves Tougard

**Area:** 11600.0 m2

**Project Year:** 2010

**Photographs:** Max Lerauge – LMCU, Philippe Ruault, Vincent Fillon

**Manufacturers:** Ductal®

**Project Name:** Lille Modern Art Museum

[Extrait images]

